

AUDIO CONTROL SWITCH REMOVAL/INSTALLATION

B3E092000148W01

1. Disconnect the negative battery cable.
2. Remove the driver-side air bag module.(See [DRIVER-SIDE AIR BAG MODULE REMOVAL/INSTALLATION.](#))
3. Remove the steering wheel.(See [STEERING WHEEL AND COLUMN REMOVAL/INSTALLATION.](#))
4. Remove in the order indicated in the table.

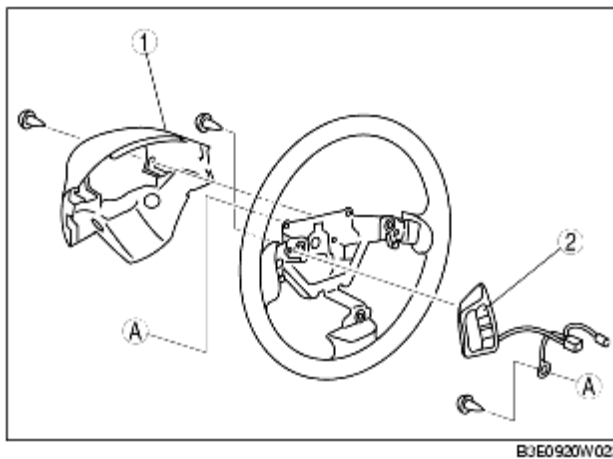

1	Cover
2	Audio control switch (See Audio Control Switch Installation Note.)

5. Install in the reverse order of removal.

Audio Control Switch Installation Note

1. Install the audio control switch so that the audio control switch wiring harness passes behind the steering wheel as shown in the figure.

